

Schedule of Areas for Community facilities

- Community Facilities / Refurbishment
- Communal Corridor
- Proposed Nursery Facilities
- Proposed Extension - 140m²

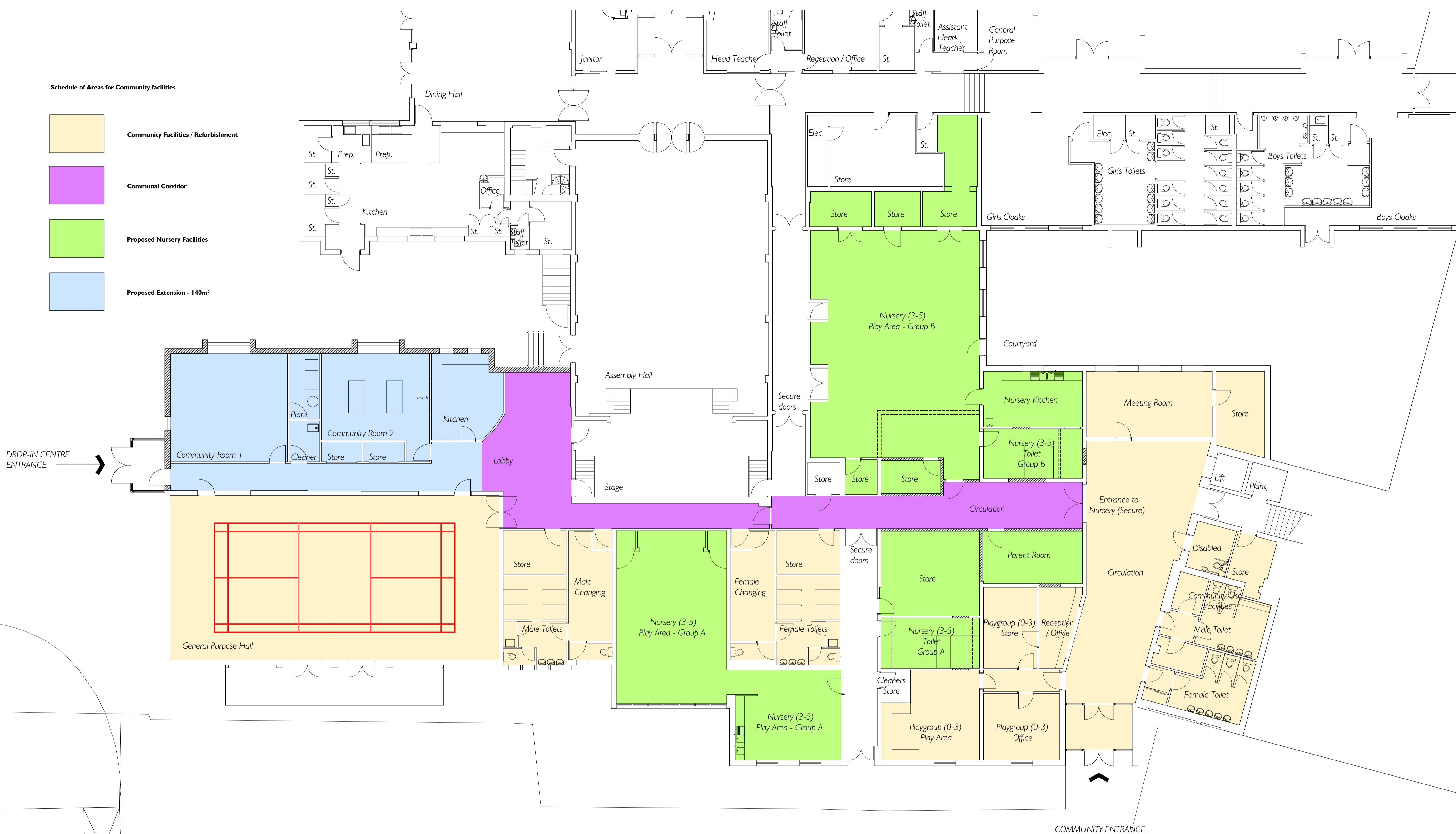

Ground Floor Plan

Aberdeenshire COUNCIL Property

The Town House Low Street Banff AB45 1AY Tel. (01261) 813200 Fax (01261) 812413

job title **CANAL PARK FACILITIES RELOCATION-MACDUFF DROP-IN CENTRE**

drawing title **ALTERNATIVE PROPOSALS - GENERAL ARRANGEMENT**

scales 1:100 contract drawing numbers **14964a12** revision master

date May 13 drawn by AMS

Property is part of the Transportation and Infrastructure Service