

From mountain to sea

Low Cost Shared Equity FOR SALE

Crichie Meadows, Stuartfield

2 x 2 bed semi detached houses for £128,140
1 x 3 bed semi detached house for £145,614



Low Cost Shared Equity - Property Schedule

Properties Available

2 x 2 bed semi detached houses
1 x 3 bed semi detached house

Heating Type

Daikin Air Source Heat Pump

Floor Space

2 bed – 70sqm
3 bed – 82sqm

Accommodation

2 bed- GF – Open plan kitchen/living/dining room and WC. FF – 2 bedrooms and a bathroom.
3 bed – GF – Open plan kitchen/living dining room and WC. FF – 3 bedrooms and a bathroom.

Garden

Private gardens

Parking Arrangements

Off street on a driveway

Properties Available From

Summer/ Autumn 2024.

Price

2 bed house - £128,140
3 bed house - £145,614

Income Threshold

2 bed Income Threshold - £48,000 or less
3 bed Income Threshold - £54,000 or less

Factoring

Provided by Greenbelt – further details available from developer.

Eligibility Criteria

See Guidance Notes for Eligibility Criteria.

Closing Date

Applications should be returned as soon as possible. Applications will be assessed on a first come basis.

Disclaimer

The information in this schedule has been supplied by the developer and is for guidance only and whilst every care has been taken in the preparation of this schedule and the information is believed to be correct, it does not warrant or constitute any offer or contract and may be subject to change.

Floor Plan – 2 bed

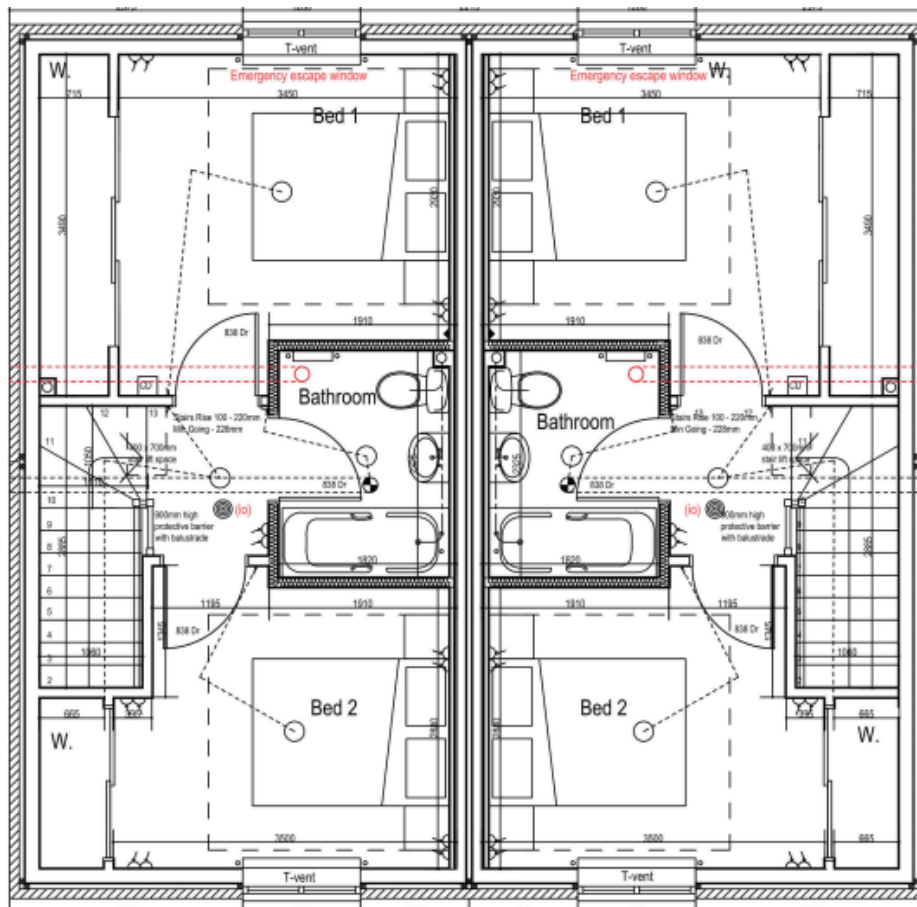
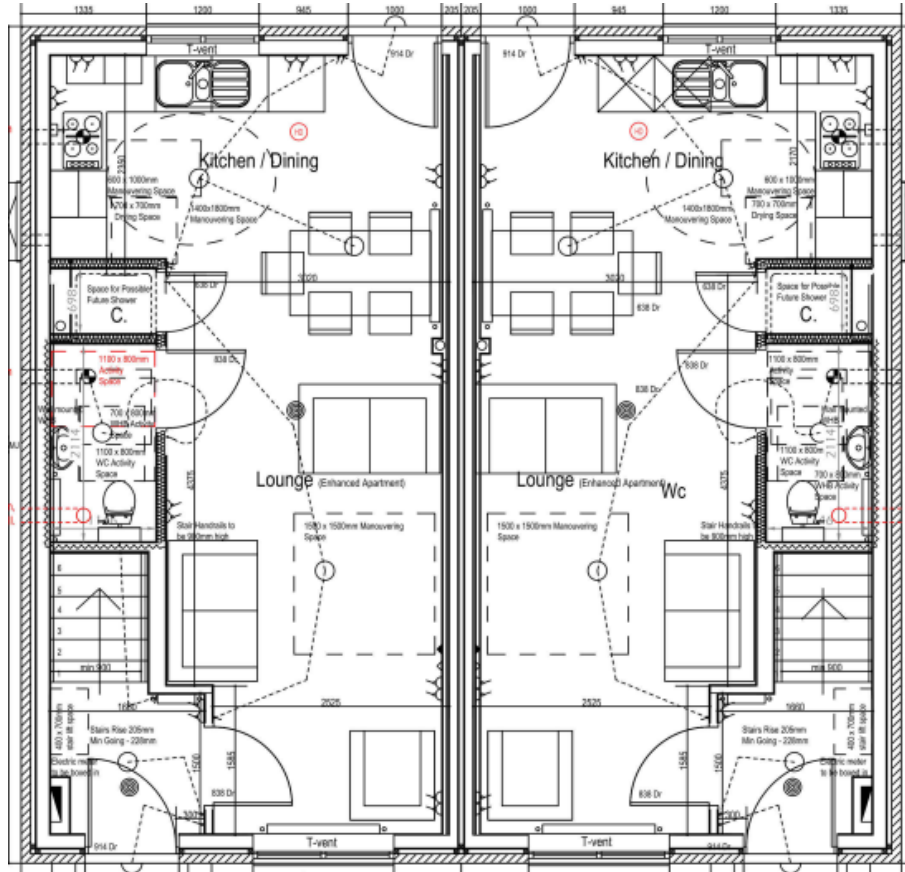

Floor Plan – 3 bed

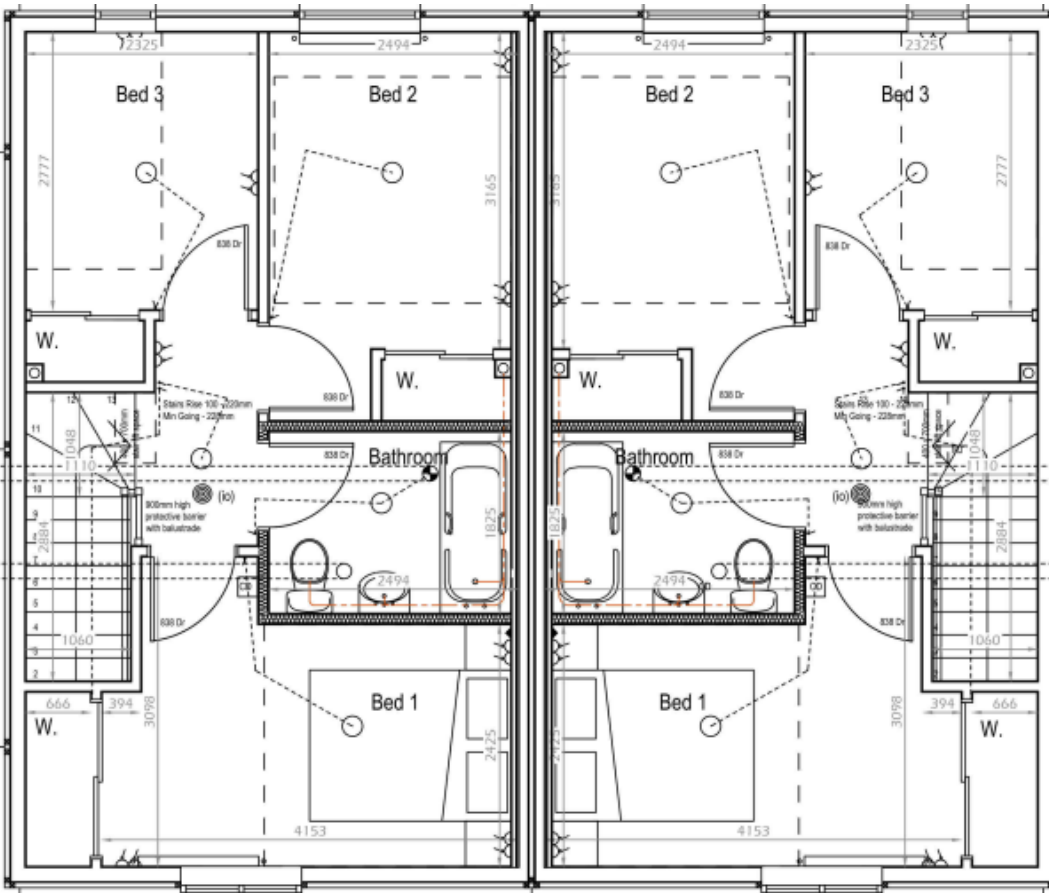
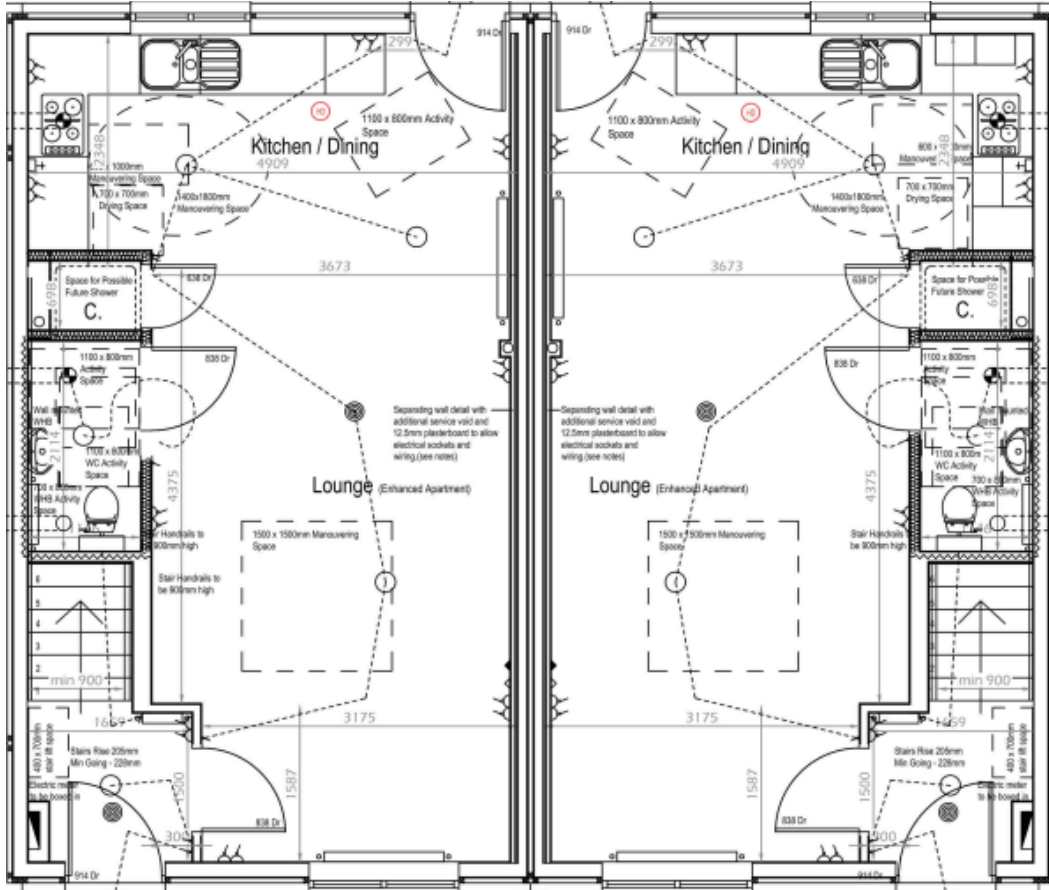

Location



Stuartfield is a quiet rural village in pleasant country surroundings within easy commuting distance of Peterhead, St Fergus and Aberdeen. Amenities include a local shop, village hall, play park and primary school. Mintlaw is located 2-3 miles away and provides secondary education, a variety of shops, pharmacy and health centre.



Further Information

For further information please contact:

Development Officer - 01467 534685

LCHO@aberdeenshire.gov.uk