

Line wires to be tightly strained between straining posts, secured and fixed to posts and stobs by staples driven to a running fit.

All wires shall be strained using ratchet winders of mild steel straps 44 wide, fitted with 25 steel spindle and ratchet device, all galvanised staples shall be galvanised mild steel No.8 Gauge and 40 long.

7. Woven wire shall be made from galvanised steel wire and shall be B832/6 heavy style. Top and bottom horizontal wires shall be No. 8½ Gauge and intermediate horizontal and vertical wires shall be strained between strainers.

NOTES

- All dimensions are in millimetres unless otherwise stated.
- Timber shall be sound, well seasoned and if mature European larch or oak is used it can be untreated. All other timber is to be barked and pressure treated with an approved preservative Cl.2641.
- Straining posts shall be at least 2150 long and 180 diameter at top. They shall be securely set not less than 1000 in the ground and placed at ends and corners, at acute variations of level and at not more than 150 metre intervals on straights.
- Turning posts shall be at least 2150 long and 150 diameter at top, and set at least 1000 in the ground at changes of direction.
- Struts shall be 1800 long at least and 100 diameter if sawn 100 x 100 and shall be fitted to all straining posts in the direction of each line of fencing. The ends below ground shall rest on a base-plate.
- Stobs shall be at least 1670 and 75 x 75 square. They shall be placed at 2000 centres and driven at least 520 into the ground.

8. Line wire shall be made from galvanised mild steel wire. Barbed wire to be attached to the bottom of the woven wire, another barbed wire to be placed 100 below top of posts. No.8 Gauge wire to be attached to the middle and top of the woven wire.

9. Woven wire to be Rylock or similar approved make.

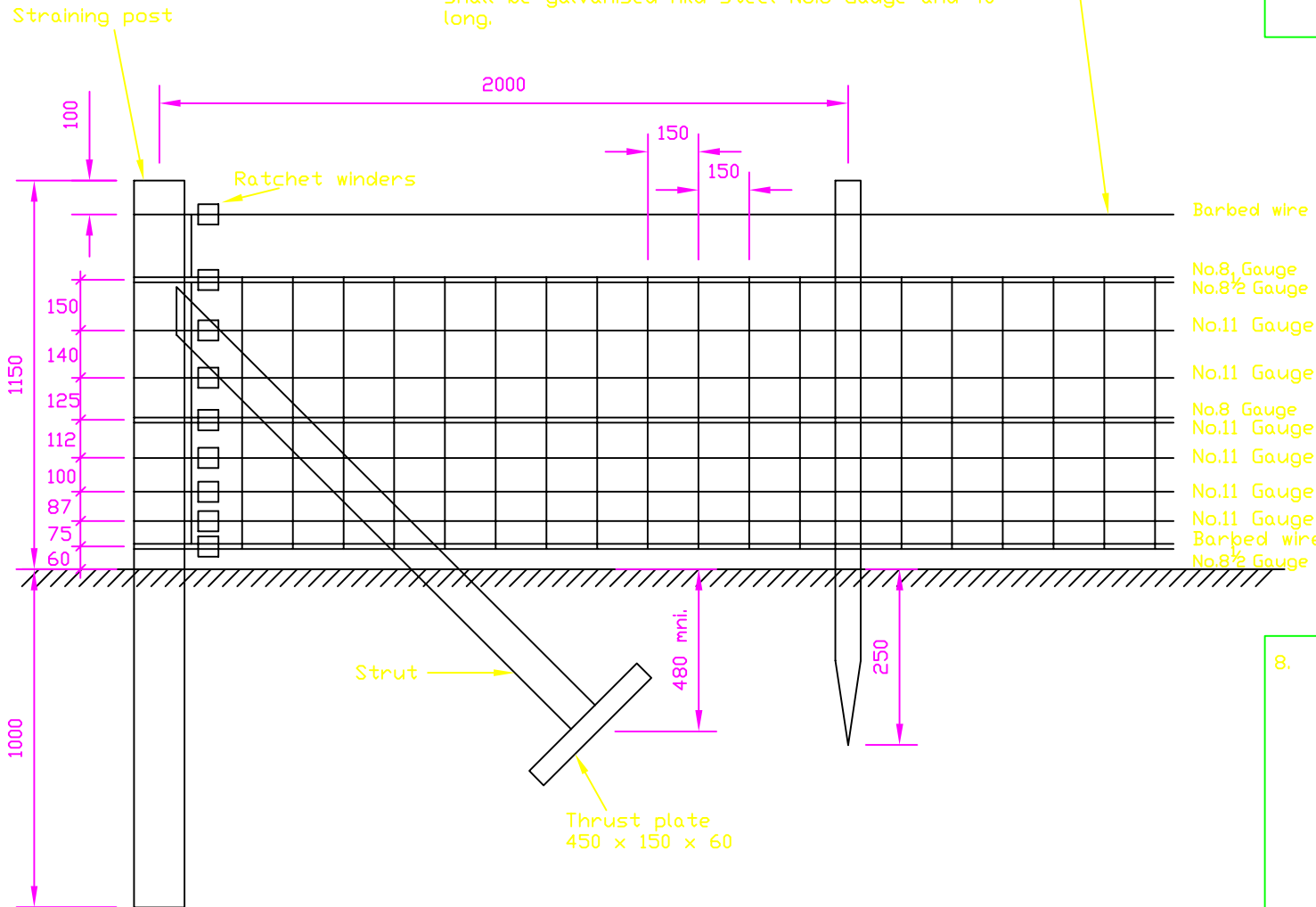

No.	Date	Description
		AMENDMENTS

Drawing No.
H76

HIGHWAY CONSTRUCTION DETAILS

FENCES, STYLES AND GATES

WOODEN POST AND WOVEN WIRE FENCE